

# Tonerider Telecaster Wiring

Thanks for purchasing a Tonerider Telecaster Pickup. By far the easiest way to a trouble-free installation is to carefully note down the solder points of your previous pickup before removal.

## Polarity.

All our TRT series pickups use a reverse-wound neck pickup for noise-cancelling operation, but we cannot guarantee that they will be in phase with telecaster pickups from other manufacturers.

- Neck: South Pole Up / Clockwise Wind.
- Bridge: North Pole Up / Counter-clockwise Wind

## Wiring Overview:

The black wires represent electrical ground, and should be soldered to any ground point, most commonly the rear of the volume control pot. On the neck pickup, the yellow wire is the "hot" wire and should be connected to the correct lug on your five-way switch. One bridge pickups, the white "hot" wire, which should also be connected to the five-way switch.

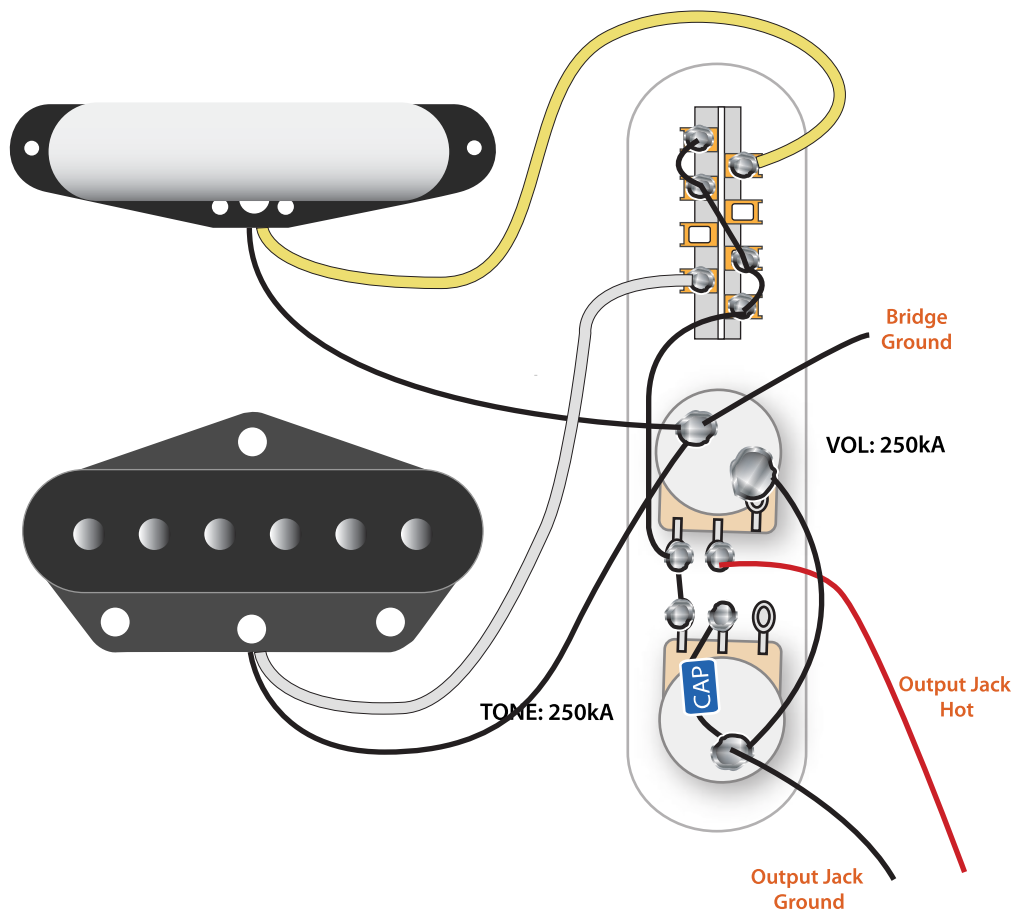

## Capacitor and Potentiometer Values

We design all our telecaster pickups to perform with the most standard industry configurations - 250k Audio pots and 0.047uf capacitors. A 0.02uf capacitor will roll off less high-end and is a good alternative. Players who like very bright tele tones might like to experiment with 500k or even 1MEG volume pots.